

# USER MANUAL

## Smart Bidet Toilet Seat

# Contents

---

- Thank you for purchasing our Smart Bidet Toilet Seat. Please read the manual carefully and use product correctly
- Installation should be completed by a licensed plumber



TE001



TE002



TE003

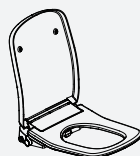

TE005



TE101

Safety notes .....	1
Product description .....	2
Product dimension .....	2
Component description .....	5

**Before use**

Installation steps .....	6
Function Introduction .....	8

**Installation and use**

Cleaning and maintenance .....	9
Product technical specification .....	10
Faults and solutions .....	10
Warranty Card .....	11

**Other matters**

## Safety notes

Read the safety instructions carefully before use so as to properly use the product.  
Note the following warnings relevant to the safety.

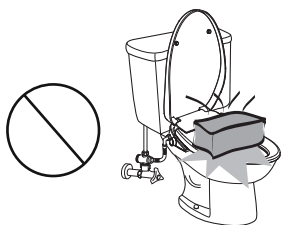

Do not place heavy objects on the toilet seat or the toilet cover

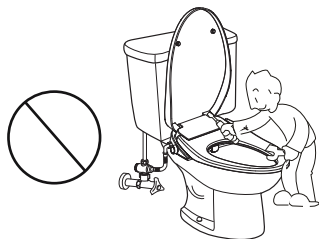

Do not disassemble, repair and modify products by without authorization.

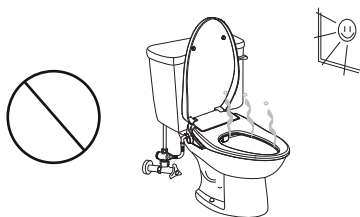

Do not place this product in direct sunlight.

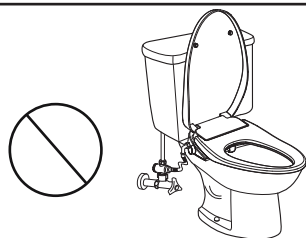

Do not bend or twist the water supply hose.

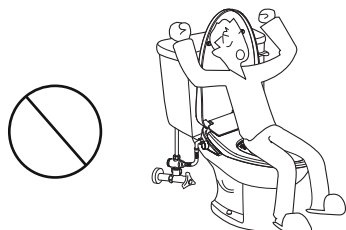

Do not lean against the toilet lid when in use

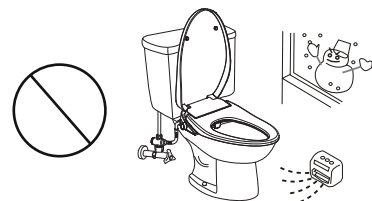

The room temperature of toilet shall be above 0°C.

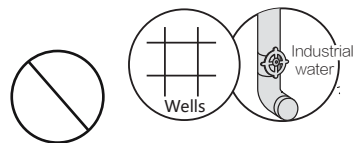

Do not connect to the substandard water pipe.



Please clean with diluted bathroom cleaner or warm soapy water. Do not use the following items: Benzene, paint thinner, detergent powder, nylon brush, etc.

# Product description

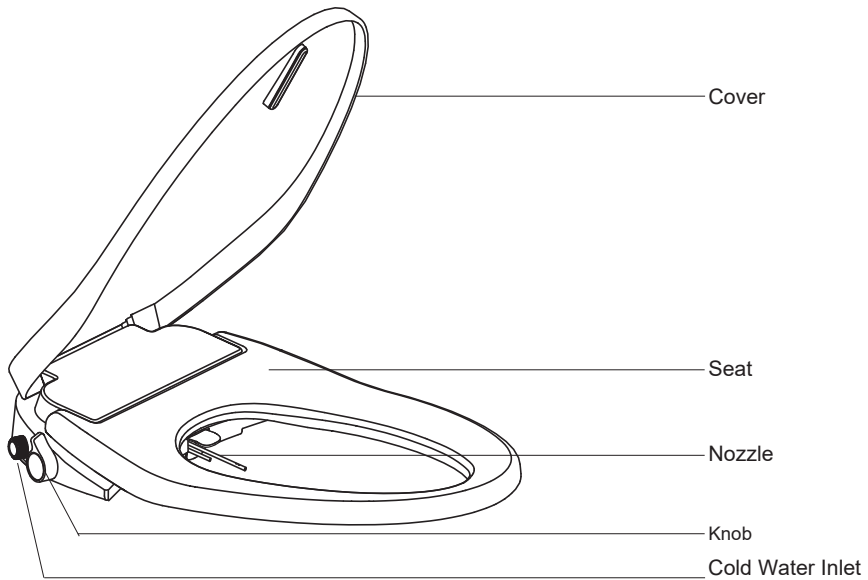

## • Product dimension drawing

TE001

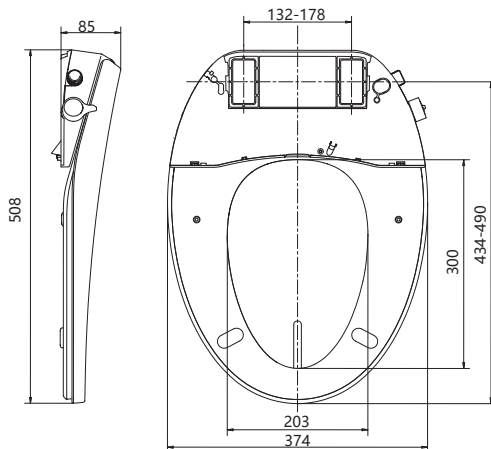

size: mm

# Product dimension drawing

---

TE002

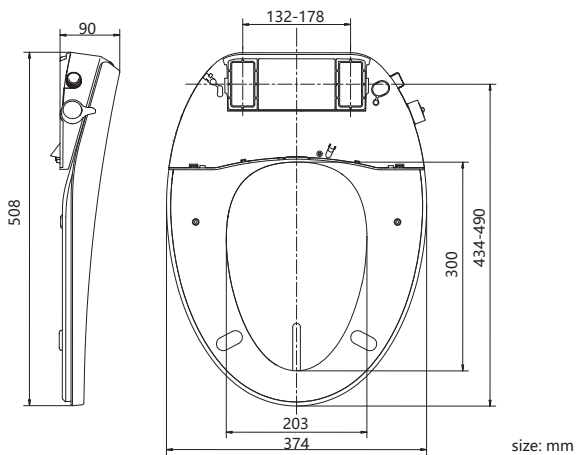

TE003

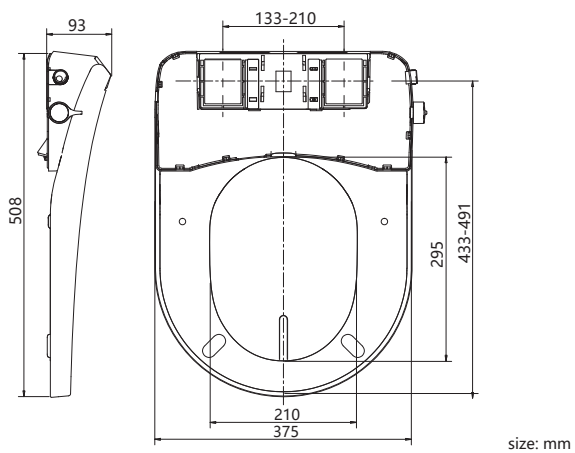

# Product dimension drawing

TE005

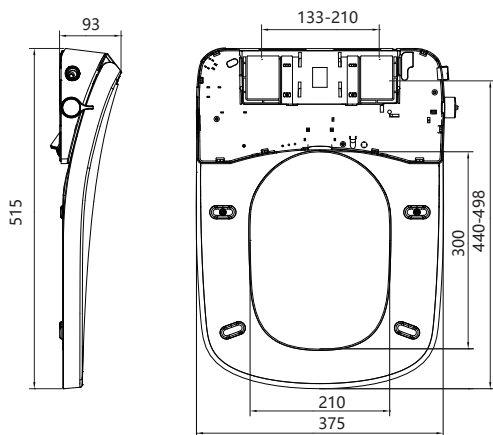

size: mm

TE101

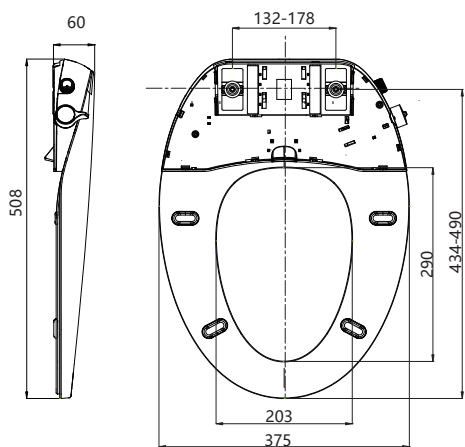

size: mm

# Component description

---

1. Cover plate

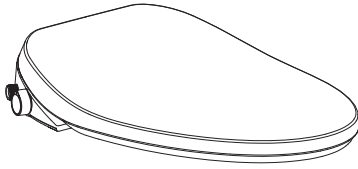

2. Installation template

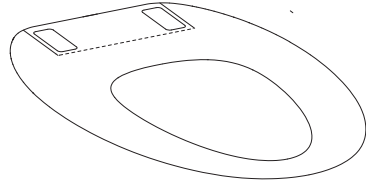

3. Fixing Parts



Screws (2)



Adjustment Sheet (2)



Adjustment Plate (2)

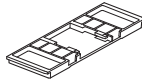

Fixing Plate



Rubber Expansion Bolts (2)

4. Adapter

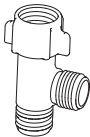

5. Water inlet hose



Filter screen

6. User manual

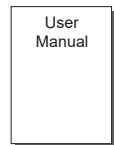

# Installation steps

## • Installation tools



Screwdriver

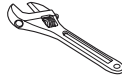

Adjustable wrench



Bucket and cloth

## • Attention before installation

1. Water pressure range: 0.07-0.75MPa, please follow the instructions.
2. Water Supply Valve shall be located close to the location where this product is installed and disassembled.
3. Please use the Water inlet hose that comes with the product to prevent water leakage.
4. When installing Water inlet hose, be careful to prevent the black gasket falling out.

## • Installation Procedure

1. Loosen the nut connecting and remove the old cover.



2. Place the installation template on the ceramic as shown. Align it with the rim of toilet.

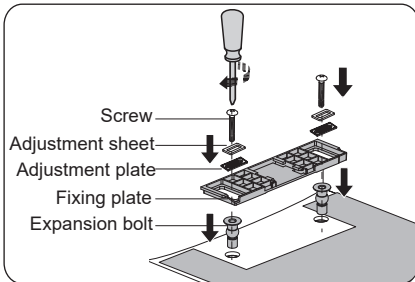
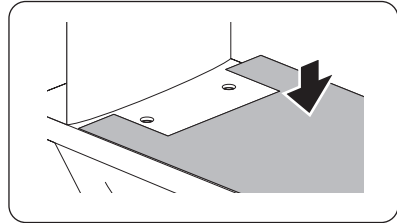

3. ① Insert the rubber expansion bolt into ceramic hole  
② Place fixing plate in notch part of template  
③ Place adjusting sheet and plate in fixing plate  
④ Align screws with rubber expansion bolt and tighten

5. Slightly push the cover into fixing plate until you hear a "CLICK", indicating that the cover has been installed in place.

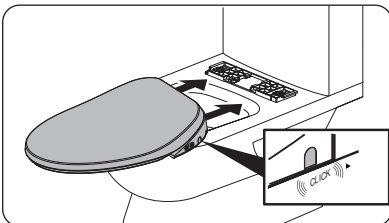

6. Close the water supply valve.

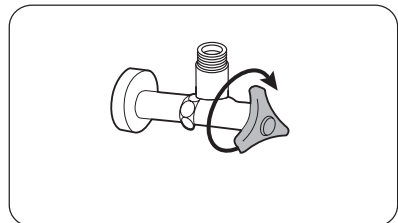



# Installation steps

## 7. Install Water inlet hose

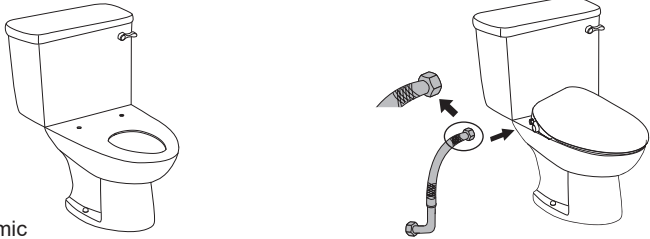

European ceramic

① When the ceramic is similar to the figure above, we suggest connecting the straight end of the hose to the cover

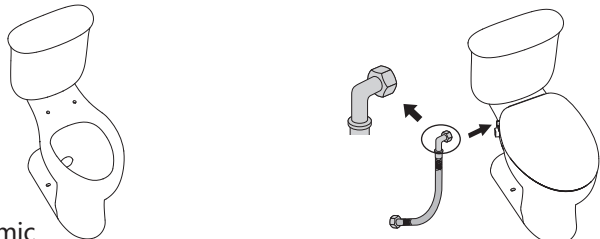

American ceramic

② When the ceramic is similar to the figure above, we suggest connecting the elbow end of the hose to the cover

## 8. Connecting flexible hose ;

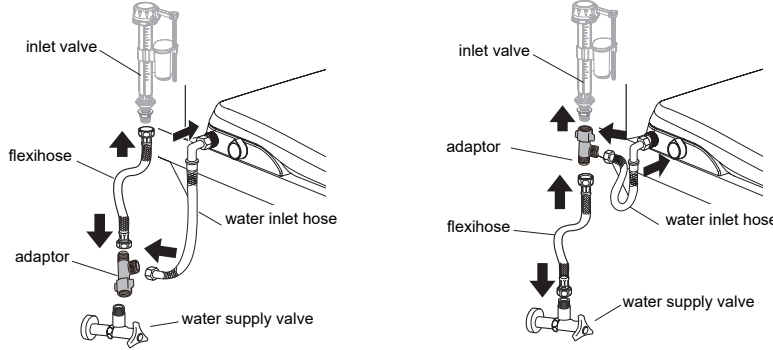

Normally, the adaptor is installed on the water supply valve

If the water supply valve and wall is too close, you can installed the tee under the inlet valve

# Installation steps

9. Open the water supply valve to check water leakage.

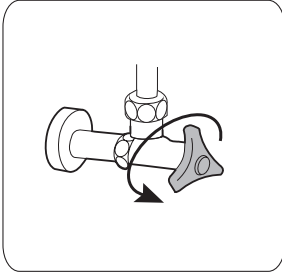

10. Turn on the knob to check whether the nozzle is protruding;

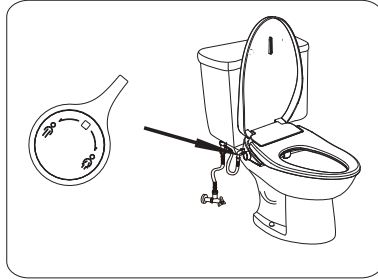

-  Prohibition
1. It is strictly prohibited to move the product from the toilet cover, otherwise easy to cause mechanical failure.
  2. It is strictly prohibited to connect hot water above 40 °C and cold water that may lead to icing.

## Function Introduction

### • Knob function

1. Rinse function

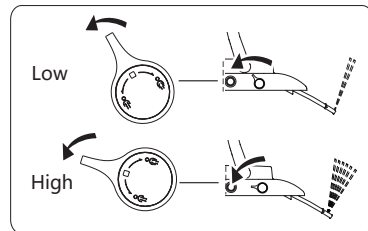
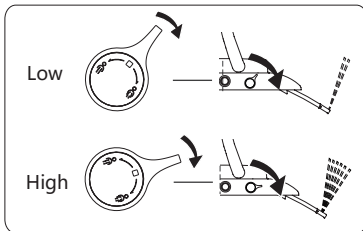

Bidet/Hip rinsing

Rotate knob to adjust amount of water

**Note:** Please open the knob to the maximum before use, and then adjust the amount of water and rinsing force through the knob.

## Cleaning and maintenance

### • Manual cleaning of spray tube

- Gently pull out the nozzle and dip the neutral detergent with a soft cloth, sponge or small brush.
- Gently support the nozzle, wipe the spray tube and nozzle.

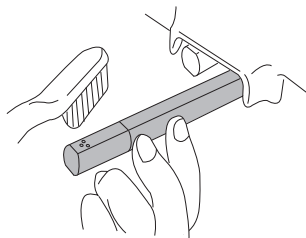

### • Clean filter screen

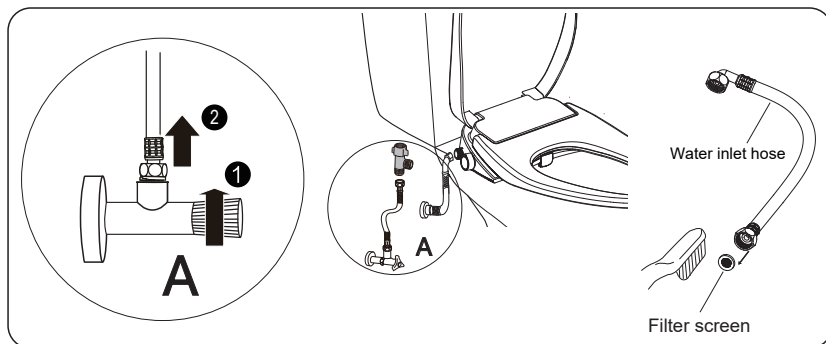

### **i** Tips:

- Make sure that the water supply valve is closed off before you clean the filter screen.
- Clean the filter screen when the water flow is less than normal hours.
- During cleaning process, the product must be thoroughly separated from the water inlet hose;
- Reinstall the filter screen in reverse order after cleaning.

### • Product surface cleaning

- Wipe the product surface with a sponge or soft cloth dampened with room temperature water or a neutral detergent.
- Lift the upper cover and the seat ring when cleaning other parts with cleaning agents.
- Do not put cover on before the cleaning agent in the ceramic toilet is completely washed, otherwise the surface may be corroded by the evaporation of cleaning agent.

## Product technical specification

Items		Description			
Model		T001-110			
		T002-110			
		T003-110			
		T005-110			
		TB101-110			
Water supply pressure		0.07-0.75MPa			
Water supply temperature		Water at room temperature			
Ambient temperature		0 ~ 40°C			
Net weight		T001/TB001	T003	T005	T0101
		About 2.2kg	About 2.5kg	About 3.0kg	About 2.0kg
Cleaning device	Water amount regulation	Stepless regulation			
	Protective device	Anti-siphon valve + anti-backflow valve			
Others	Antibacterial material	Nozzle			
	Control operation	Knob			

## Faults and solutions

Problem	Possible cause	Solution
Low flushing	Knob is not completely turned on	Increase knob regulating angle
	Water pressure too low	Contact relevant departments to solve water pressure problems
Turn on knob and no the water comes out	Valve off	Open the valve
	The filter of the water inlet pipe is blocked	Clean the filter of the water inlet pipe
	Nozzle clogging	Remove the nozzle and clean it
Spray rod cannot reset	Water quality is too hard and the spray rod	Clean spray rod
Base leaking	Water pressure too high	Contact relevant departments to solve water pressure problems

# Warranty Card

## To Customers:

Thank you for choosing our products. If any problem occurs during use, please refer to the user manual. If you cannot resolve the problem, please contact your local supplier or call the service hotline.

### Information:

Customer information	Customer name		
	Address		
	TEL		
Dealer information	Name		
	TEL		
Model		Product series number	
Purchase date	Y	M	D
		Warranty period	One-year free

### Notes to warranty card:

1. Please complete the warranty card.
2. Warranty cards and invoices are important for the warranty service. If the product failure occurs during warranty period, please show the warranty card and the invoice when the dealer or after-sales service personnel of the Company provide on-site maintenance and repair.
3. The warranty card cannot be reissued, please keep it properly.

During the warranty period, the Company will provide repair free of charge according to the use instructions, precautions for normal use.

### Key Points:

1. Out of warranty.
2. The valid invoice and warranty card cannot be provided during the warranty period.
3. Failure or damage caused by transportation, collision after purchase.
4. Product damage during abnormal use, failure and damage during the warranty period caused by human factors or natural disasters, such as fire, earthquake, flood, lightning or environmental pollution, etc.
5. Failure or damage caused by unauthorized disassembly, modification or maintenance due to user's cause or responsibility.
6. Failure or damage caused by violation of maintenance regulations in use, such as improper use of cleaning agent or wiping and maintenance methods not compliant with maintenance requirements.
7. The consumable items (such as sealing rings, etc.) or products have failed or damaged due to sand and impurities.
8. Conduct the secondary transfer according to the customer's requirements.
9. Product not installed by licensed plumber

